

HIGH SPEED CHEQUE & REMITTANCE ADVICE IMAGE SCANNER WITH AUTOFEEDER

» FB-20

The FB-20 is one of the fastest portable cheque & remittance advice image scanners, designed for both front and back office operations environments.



- » Ideal for high volume cheque & remittance advice scanning
- » High speed cheque & remittance advice scanning with auto-feeder/ auto-hopper instead of manual feeding
- » High quality front and rear images MICR & remittance advice capture in B/W (bi-tonal), greyscale and colour
- » Capture full cheque & remittance advice image (both front & rear) simultaneously with MICR & remittance advice data & endorsement for audit purposes
- » When combined with SMARTCAPTURE™, FB-20 scans, stores, archives and retrieves all scanned information

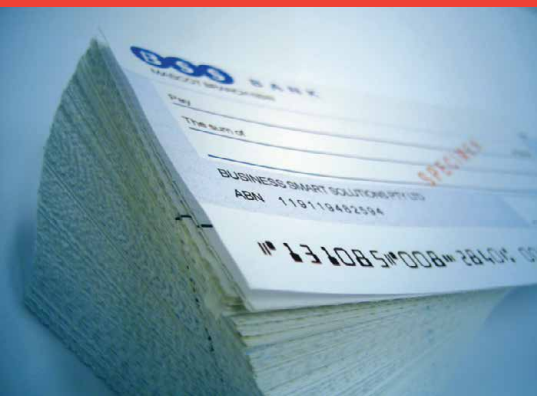

Scanning, storing, archiving and retrieving cheque & remittance advice image and MICR data can now be easy, flexible and accurate without compromising time, effort and money.

When compact footprint, cutting-edge technology and speed are needed, the FB-20 is the ideal solution to give your business a competitive advantage in processing cheque and remittance advice.

The FB-20 meets real world demand without having to make great expenditures. The FB-20 has the ability to scan and endorse cheque and remittance advice images, as well as read MICR & remittance advice OCR data efficiently and conveniently.

The FB-20 is equipped with a document auto-feeder that holds up to 100 cheques and remittance advice at a time and dual-pockets to separate valid & invalid cheques or cheques & remittance advices.

At 97 documents per minute, as well as capturing both front and rear images of cheque & remittance advice documents in bi-tonal, grey-scale and colour, the FB-20 is the sharpest tool in creating swift and effortless operations.

Also, its USB 2.0 plug-and-play connection makes integrating to PCs convenient.

FB-20 is integration capable with SMARTCAPTURE™, a solution that allows the user to obtain cheque and remittance advice images and MICR and remittance advice data with its user-defined and flexible search criteria for faster and more accurate data retrieval.

FEATURES

- Process up to 97 cheque & remittance advice documents per minute
- Auto document feeder holds up to 100 cheques & remittance advices with double-feed detection
- Convenient dual-pocket sorter separated into valid & reject or cheque & remittance advice.
- Built-in endorser with ink jet printer for validation
- Double-sided image scanner with bi-tonal, greyscale and full colour options
- Easy integration to other applications
- Scan high image resolution up to 300 dpi

Sample of front cheque & remittance advice image capture



Sample of MICR data capture

Sequence	Header	Serial	BankCode	Account	TC	Amount	Type	Pocket	OSerial
0001017620	1121	009010	009-0023	0023101234	50	10,000,000.00	CR		5 009010
0001017630	144	000023	025-9999	0000000000	96	55,000,000.00	DB		5 000002
0001017640	2145	011003	011-0042	0042345678	50	3,000,000.00	CR		5 011003
0001017650	96	011001	011-0042	0042123456	50	1,000,000.00	CR		3 011001
0001017660	96	011008	011-0042	0042890123	50	8,000,000.00	CR		3 011008
0001017670	2145	011010	011-0042	0042101234	50	10,000,000.00	CR		5 011010
0001017680	96	011009	011-0042	0042901234	50	9,000,000.00	CR		3 011009
0001017690	4193	011007	011-0042	0042789012	50	7,000,000.00	CR		5 011007

Convenient dual-pocket sorter to separate valid & invalid documents or cheque & remittance advice

Automatic document feeder holds up to 100 cheques

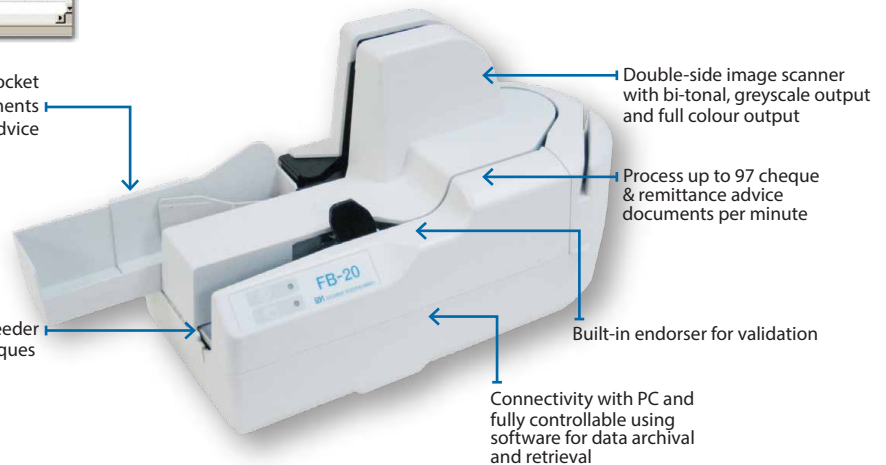

SPECIFICATIONS

FB-20

Document Feeder	Type : Auto hopper with the Ultra-Sound double feed detection Capacity : 100 documents (with 0.116mm thickness document) Document length : 80 - 240mm Document height : 50 - 120mm Document thickness : 0.095 - 0.156mm
MICR Reader	Font read : E13B, CMC7 (selectable) Number of characters : 65 characters or less Recognition rate : More than 99%
Endorser	Print Head type : Ink jet printer Character size : 7.5cpi, 10cpi, 15cpi Vertical print position : Fixed 33mm from document bottom
Image Scanner	Capture module : Contact image sensor Capture side : Front and Rear Representation : 256 gray levels, Bi-tone(White/Black), Color(256 level x 3 primary color) Resolution : 200, 240, 250, 300 dpi Scanning area : 108(H) x 235(W)mm

Performance Table (based on 6.7" cheques)

Grayscale	200 DPI : 97 doc/min 240 DPI : 74 doc/min 250 DPI : 71 doc/min 300 DPI : 59 doc/min
------------------	--

Single Pocket	Capacity : 150 - 200 documents
PC Interface	USB 2.0
Dimensions	425(W) x 168(D) x 213(H)mm
Weight	4.7kg (AC adapter not included)
Power	AC adapter / 100-240V, 50/60Hz
Environmental Requirements (operating)	Temperature : 5 - 35°C Humidity : 30 - 80%RH
System Requirement	Operating System : Windows XP / Vista PC performance : Processor: Intel® Pentium® 4, Core™ 2 Duo or more Memory : 1GB or more
Certification	CE, UL, CSA, FCC, CCC / RoHS, WEEE, China RoHS

Color	200 DPI : 58 doc/min 240 DPI : 26 doc/min 250 DPI : 26 doc/min 300 DPI : 23 doc/min
--------------	--